

## Playgrounds and Recreation Centers

### Stenton Park Recreation Center and Playground



*Accessible playground and sprayground site plan*

VLS partnered with the Philadelphia Department of Public Property to redesign the playground at Stenton Park in North Philadelphia. Viridian designed a playground and sprayground that is fully accessible and provides a range of equipment for toddlers to teenagers. The sprayground greatly improves upon the existing spray feature (a single wall mounted spray on the north side of the building) by relocating it as a central play space with spray hoops that can be used for play even during the off-season. The site preserves almost all of the existing mature canopy trees by working around existing paved areas and minimizing grading within the canopy.

### Greening Greenfield Albert M Greenfield Elementary School



*Phase 2 Rubber Surface Mounds and porous surface infiltrate stormwater*

The design for Greenfield Elementary transforms the site into a living laboratory that teaches children about microclimates and other aspects of the natural environment. Bioswale with check dams slow run-off, allow absorption and are planted with a lush variety of native plants. The landscape evapotranspires stormwater, provides shade, and creates a mini native Pennsylvania forest ecosystem. Rain gauges, rain barrels & green roofs allow students to document and observe alternative technologies.

### Palmer Playground Upgrade

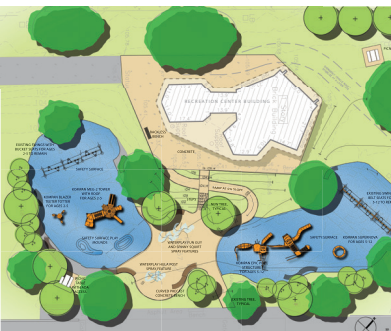

*Accessible playground and sprayground site plan*

VLS partnered with the Philadelphia Department of Public Property to upgrade Palmer Playground in Northeast Philadelphia. The sprayground is relocated to a more centralized location between the 2-5 and 5-12 playgrounds. It also calls for eliminating the existing ramp and building a new ramp that works with the hill. More trees will supplement the shade provided by existing trees. The addition of picnic tables gives visitors a place to sit and gather for lunch while watching a softball game.

### Fitzpatrick Playground Upgrade

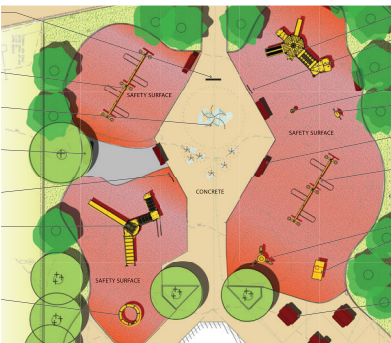

*Upgraded site plan*

Working with the Philadelphia Department of Public Property VLS designed upgrades for Fitzpatrick Playground in Northeast Philadelphia. The plan calls bringing equipment up to code and expanding the sprayground by adding ground fixtures and a new above ground spray structure. New site furniture, benches and tables, will match existing benches and provide harmony to the overall feel of the site.